

## Osłona stożkowa

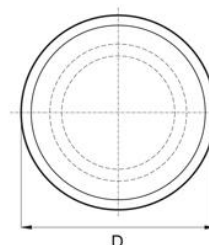

→ Materiał: polietylen

→ Kolor: naturalny

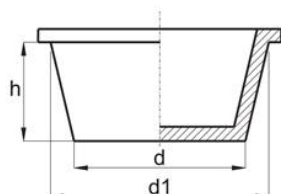

Symbol	d	d1	D	h	Gwint metryczny DIN 13	Gwint Whitworth'a DIN 259	Gwint rurowy DIN 40430
076.001	02.5	3.3	7	4.6			
076.002	06.8	8	10.5	4.5	M8/M8x1		
076.003	08.1	09.3	11	7	M10/M10x1	R 1/8"	
076.004	09.8	10.5	12	7	M12/M12x1,5		
076.005	10.6	11.82	14	7	M12x1		PG 7
076.006	11.4	12.63	15	7	M14/M14x1,5	R 1/4"	
076.007	13.3	14.5	16	7	M16		PG 9
076.008	14	15.2	17	7	M16x1,5		
076.009	14.6	15.2	18	7	M18	R 3/8"	
076.010	15.3	15.8	18	7	M18x2		
076.011	16	17.2	20	9	M20/M18x1,5		PG 11
076.012	17.4	18.8	21	9	M20x1,5/M20x2		
076.013	18.2	19.6	22	9		R 1/2"	
076.014	18.7	20	24	9	M22/M22x2		PG 13,5
076.015	19.8	21.2	24	9	M24/M22x1,5	R 5/8"	PG 16
076.016	20.3	22.6	25	14			
076.017	21.2	23.3	26	14	M24x1,5/M24x2		
076.018	23	25	28	14	M27/M26x1,5	R 3/4"	
076.019	24.3	26.4	30	14	M27x1,5/M27x2		
076.020	25.6	27.8	30	14	M30/M28x1,5		PG 21
076.021	27.2	29.3	32	14	M33/M30x1,5/M30x2/M32x1,5	R 7/8"	
076.022	30	32	35	14	M36/M33x1,5/M33x2	R 1"	
076.023	32	34	38	14	M35x1,5/M36x2/M36x3		
076.024	33.6	36	40	14	M39/M36x1,5/M39x3	R 1 1/8"	PG 29
076.025	34.5	37	40	14	M38x1,5		
076.026	36	38.4	42	14	M42/M39x1,5/M39x2		

076.027	37.9	40	44	14	M40x1,5/M42x2/M42x3		
076.028	38.5	41	43	14	M45	R 1 1/4"	
076.029	39.8	42	46	14	M42x1,5/M45x3		
076.030	41.3	43.5	47	14	M48/M45x1,5/M45x2	R 1 3/8"	
076.031	43.9	46.3	52	13.5	M48x2/M48x3	R 1 1/2"	PG 36
076.032	45.5	47.9	52	13.5	M48x1,5		
076.033	47.86	49	54	13.5	M50x1,5/M52x2/M52x3		
076.034	49.8	51.2	56	13.5	M52x1,5	R 1 3/4"	
076.035	50.5	51.5	55	14	M56x4		PG 42
076.036	52.5	54.8	58	13.5	M55x1,5/M56x2		
076.037	54.5	55.8	60	13.5	M58x2/M60x4		
076.038	55.5	56.3	61	13.5	M58x1,5		
076.039	57	57.5	63	13.5	M60x1,5/M60x2	R 2"	PG 48
076.040	58.5	60	64	13.5	M62x1,5/M64x4		
076.041	60.5	61.5	66	13.5			
076.042	61.3	63.66	67	13.5	M64x2		
076.043	62.5	63.6	68	13.5	M65x1,5/M68x4	R 2 1/4"	
076.044	63.5	64.5	69	13			
076.045	65	66.3	71	13	M68x2		
076.046	66	67.8	72	13	M68x1,5/M72x4		
076.047	67.9	68.5	74	13	M70x1,5/M72x2		
076.048	69.8	70.9	75	13	M72x1,5/M76x4		
076.049	71.5	73.5	77	13		R 2 1/2"	
076.050	72.8	75	79	13	M75x1,5/M76x2		
076.051	74	75.2	85	13	M80x4		
076.052	76.5	78.6	87	17	M80x2		
076.053	77.5	79.7	88	17		R 2 3/4"	
076.054	79	81.1	90	17	M85x4		
076.055	81.5	82.3	92	17	M85x2		
076.056	84	86.98	95	17	M90x4	R 3"	
076.057	86.5	88.3	97	17	M90x2		
076.058	89	92	100	17	M95x4	R 3 1/4"	
076.059	94	96.4	105	17	M100x4		
076.060	96.5	99.5	107	17	M100x2	R 3 1/2"	
076.061	99	101.2	110	17	M105x4		
076.062	101.5	104	112	17	M105x2		
076.063	104	106.98	115	17	M110x4		
076.064	106.5	109.5	117	17	M110x2		
076.065	109	112	120	17	M115x4	R 4"	
076.066	112	114.98	123	17	M115x2		
076.067	114	116.98	125	17			
076.068	119	123	130	23	M125x4/M130x6		
076.069	124	128	134	23			
076.070	127.5	131.5	137.6	23			
076.071	129	133	140	23			
076.072	133	137	143	23			
076.073	139	143	149	23			
076.074	146.8	150.8	159.5	23			
076.075	149	153	159	23			
076.076	153.5	157.5	163.6	23			
076.077	160	164	170	23	M165x3		