

Zaślepka do profili prostokątnych

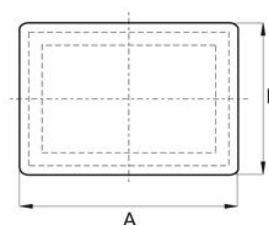

- Materiał: polietylen
- Kolor: czarny, biały, szary
- Na specjalne zamówienie: produkt w RAL lub kolory specjalne na życzenie produkt w kolorach z palety RAL lub kolorach specjalnych

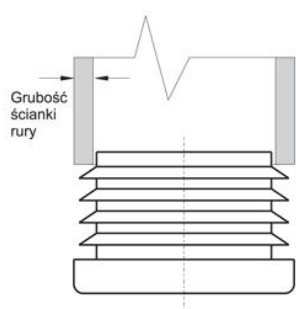

Symbol	A	B	Grubość ścianki
002.001	20	10	0,8 - 2,0
002.002	20	15	1,0 - 2,5
002.003	20	16	0,8 - 2,5
002.004	25	10	0,8 - 2,0
002.005	25	15	0,8 - 2,5
002.006	25	20	1,0 - 3,0
002.007	30	10	1,0 - 2,5
002.008	30	15	1,0 - 2,5
002.009	30	18	1,0 - 2,5
002.010	30	20	1,0 - 2,5
002.011	30	25	0,8 - 3,0
002.012	35	10	0,8 - 2,0
002.013	35	15	1,0 - 3,0
002.014	35	20	1,0 - 2,5
002.015	35	25	1,0 - 3,0
002.016	40	10	1,5 - 2,0
002.017	40	15	1,0 - 2,0
002.018	40	20	1,0 - 2,5
002.019	40	20	3
002.020	40	25	1,0 - 2,5
002.021	40	27	1,0 - 2,5

002.022	40	30	1,0 - 2,5
002.023	40	35	1,0 - 3,0
002.024	45	15	1,0 - 2,0
002.025	45	20	1,0 - 3,0
002.026	45	25	1,0 - 2,5
002.027	45	30	1,0 - 2,5
002.028	45	35	1,0 - 3,5
002.029	50	10	0,8 - 2,0
002.030	50	20	1,0 - 2,5
002.031	50	25	1,0 - 2,5
002.032	50	25	3,0 - 4,5
002.033	50	30	1,0 - 2,5
002.034	50	30	3,0 - 5,0
002.035	50	35	1,0 - 3,5
002.036	50	40	1,0 - 2,5
002.037	60	15	1,0 - 2,0
002.038	60	20	1,0 - 2,5
002.039	60	25	1,0 - 2,5
002.040	60	30	1,0 - 2,5
002.041	60	30	4,0 - 5,0
002.042	60	35	1,5 - 3,5
002.043	60	40	1,0 - 2,5
002.044	60	40	4,0 - 5,0
002.045	60	45	1,5 - 4,0
002.046	60	50	1,5 - 3,5
002.047	70	20	1,0 - 2,0
002.048	70	25	1,0 - 2,0
002.049	70	30	1,0 - 2,5
002.050	70	35	1,5 - 3,5
002.051	70	40	1,0 - 2,0
002.052	70	40	4
002.053	70	50	2,0 - 5,0
002.054	75	25	1,0 - 3,0
002.055	80	20	1,0 - 2,0
002.056	80	25	1,0 - 3,0
002.057	80	30	1,0 - 2,5
002.058	80	30	2,5 - 4,0
002.059	80	40	1,0 - 3,0
002.060	80	40	3,2 - 4,0
002.061	80	50	2,0 - 4,0
002.062	80	60	1,5 - 3,5
002.063	80	60	5
002.064	90	50	2,0 - 4,5
002.065	90	70	3,0 - 5,5
002.066	100	20	1,5 - 3,0

002.067	100	25	1,5 - 3,0
002.068	100	30	1,5 - 3,5
002.069	100	40	1,0 - 2,0
002.070	100	50	2,0 - 4,5
002.071	100	50	3,5 - 5,0
002.072	100	60	2,5 - 4,5
002.073	100	80	3,0 - 5,5
002.074	120	20	1,5 - 3,0
002.075	120	40	3,0 - 5,0
002.076	120	50	3,0 - 5,5
002.077	120	60	3,0 - 4,0
002.078	120	60	5
002.079	120	80	2,0 - 5,5
002.080	120	100	3,5 - 6,0
002.081	140	70	4,0 - 6,5
002.082	140	80	1,0 - 4,5
002.083	150	100	3,0 - 8,0